

Installation instructions

Lucernario aerante INOX Openable

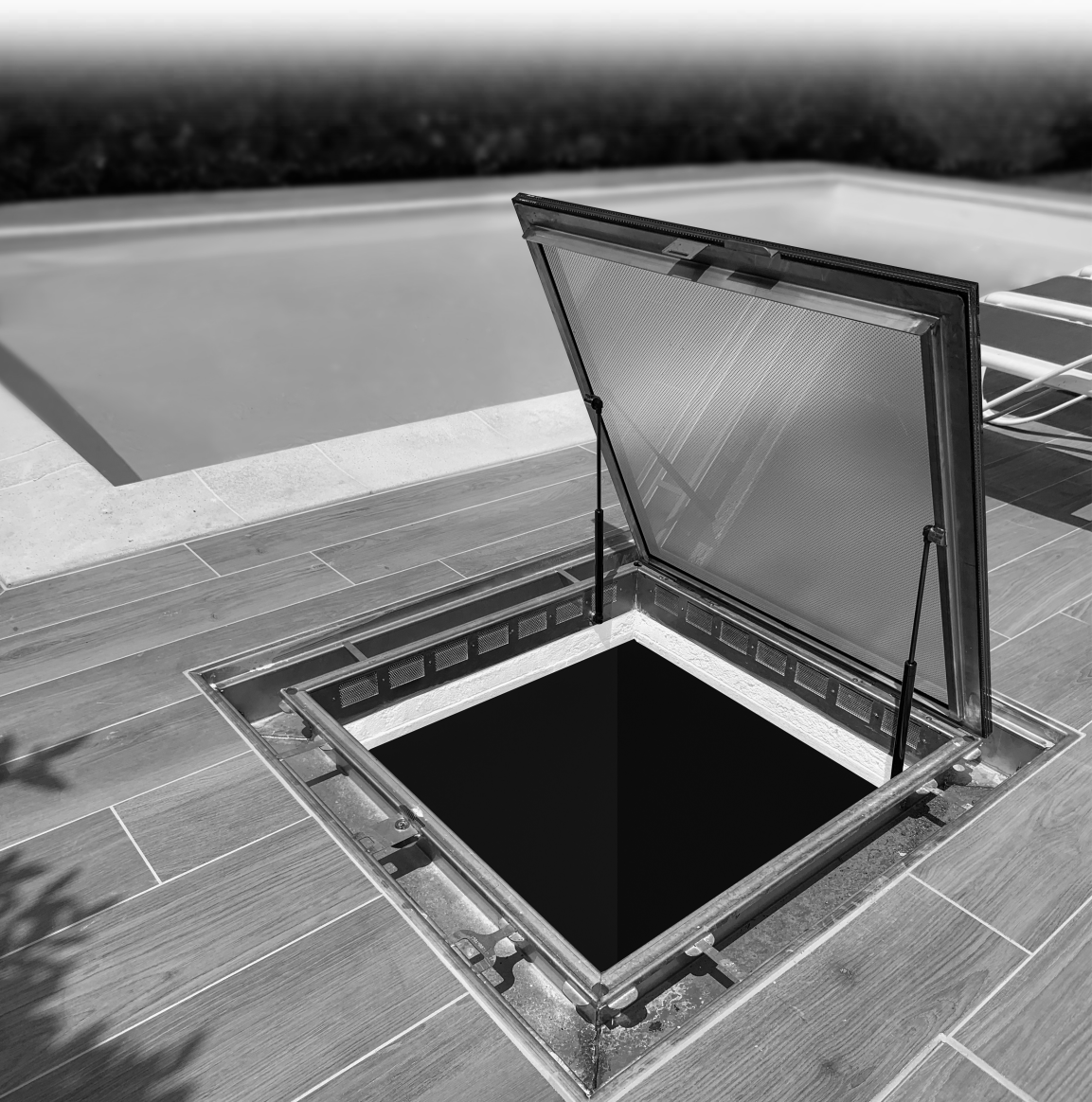

Installation instructions

Index

- Pag. 3 - Support base
- Pag. 4 - Sloping
- Pag. 5 - Before installing
- Pag. 6 - Method
- Pag. 7 - Illustrations
- Pag. 9 - Laying Diagrams
- Pag. 10 - Cleaning, Technical Assistance

Important information for correct installation

Read this information carefully before installing the product

Support base

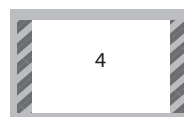
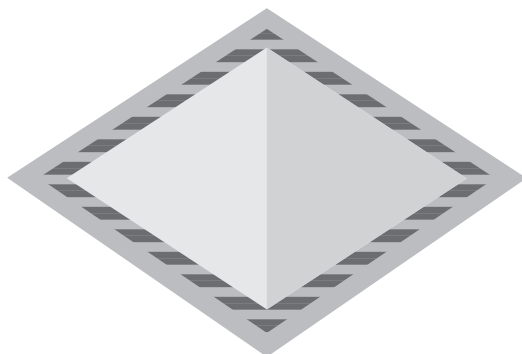

The load-bearing capacity of the Lucernario INOX Openable was tested with a support base on three adjacent sides (figures 1 and 2), but support on two opposite sides is also permitted (figures 3 and 4). Please check the technical sheet.

Support base

Yes

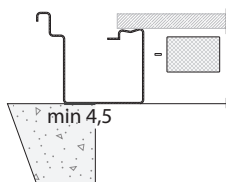

No

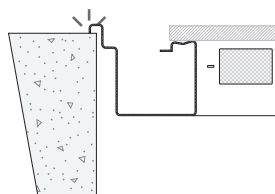

Lucernario must rest on reinforced concrete for at least 4.5 cm of its base.
We prohibit any other method of support.

Important information for correct installation

Read this information carefully before installing the product.

Pendenza minima: 1%

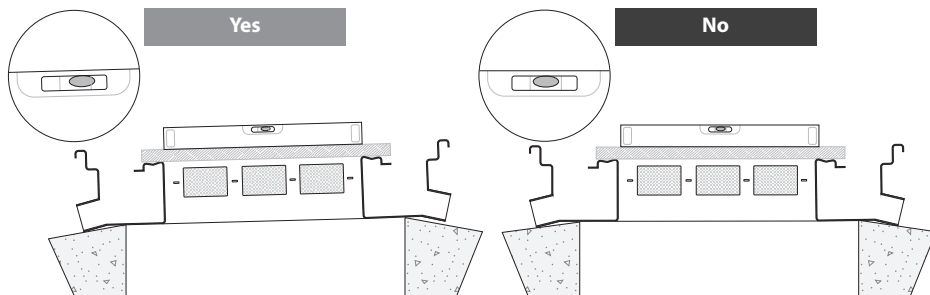

ATTENTION !

Lucernario aerante it must not be used as a drainage grate when there is a need to manage large quantities of water. In these cases it is a good idea to install independent drainage channels that allow rapid water flow without overloading the Lucernario. Failure to comply with these good rules can cause water to spill inside the light well.

Drainage pipes

Lucernario aerante Openable is equipped with 4 drains.

Connect at least 2 drains with PP pipes Ø 50 mm and plug the other 2 with the supplied cap.

For further information on the characteristics of the product, consult the Technical Data Sheet.

Installation Instructions

Before installing

- 1) Remove the surface grid and store it in a protected place.

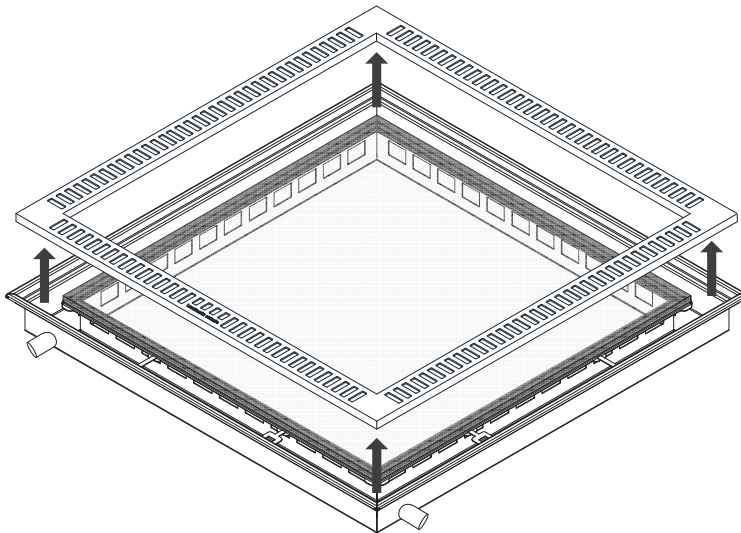

- 2) Protect the glass surface with cardboard or bubble wrap.

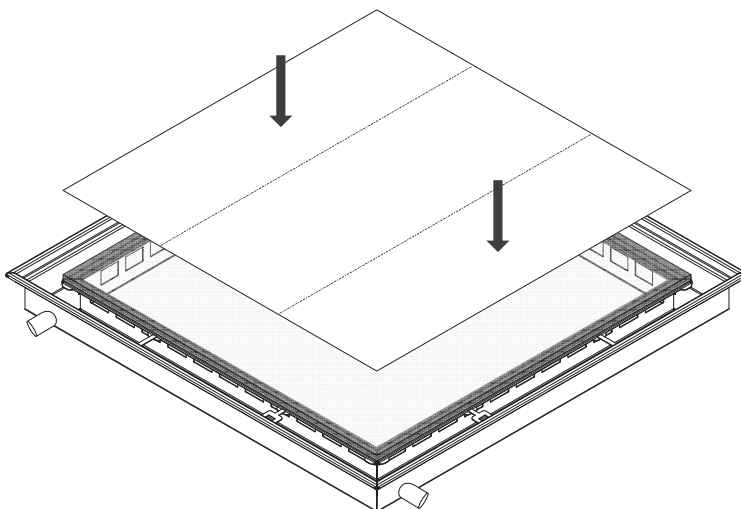

Illustrations may show a different product.

Installation Instructions

Installation

Premise: Lucernario Aerante is installed without any subframe.
Its structure is designed to be incorporated into the stratigraphy of the floor.
The laying diagrams are shown on Page 9.

Method

1. Place the Lucernario on the prepared hole inside the slab (refer to the dimensions in the Technical Data Sheet).

ATTENTION: read the weight of the product on the adhesive sticker or on the Technical Data Sheet before moving or lifting it.

2. Position the Lucernario on slope (page 4: Minimum slope).

ATTENTION: The presence of the drain does not indicate that the structure of the drainage channel has its own inclination towards it, only the correct sloping installation of the Lucernario guarantees fluid water evacuation through the channel.

3. Use the necessary thicknesses to ensure that the surface of the product equals the level of the finished floor.

Check the stability of the support and verify that the given slope is sufficient. You can check by pouring a glass of water into the drain and observing the flow.

4. Plug the two drains that do not receive water with the plugs supplied or channel all 4 drains (page 4: Drain pipes).

5. Fix the position of the Lucernario to the base with low or no shrinkage concrete¹.
Close any gaps between the slab and the Lucernario.

6. Lay a roll of bituminous membrane on the concrete slab and fold it along the external vertical part of the Lucernario.

Add additional layers of sheathing to cover the entire perimeter of the skylight (Figure A).

7. Heat the sheath so that it adheres to the Lucernario.

WARNING: Do not directly hit the Lucernario with the flame.

8. Join the sheath on all sides and corners of the Lucernario, taking care to cover every crack to avoid water infiltration (Figure B).

Do not extend the sheath to the top of the product so as not to expose it to the elements: respect the sheath limit (Figure C).

9. Repeat operations 6, 7 and 8 by applying a second layer of bituminous membrane.

10. Spread liquid waterproofing (for example, liquid bituminous membrane) between the sheath and the vertical edge of the Lucernario, in order to guarantee the grip of the sheath during the subsequent laying operations of the floor body (Figure D).

11. Connect a 50 mm diameter polypropylene pipe equipped with a gasket to each drain of the Lucernario.

12. Make sure that all assembly phases have been carried out correctly; wait for the sheaths to solidify and finally proceed with the construction of the remaining floor body.

13. Remove the glass protection and reposition the removable grille only when work is completed.

¹: Common concrete is not recommended because it tends to shrink during drying.
In such cases the Lucernario could lower from the pre-established position.
The use of specific cements is recommended.

Installation Instructions

Illustrations

Figure A: Laying of sheath

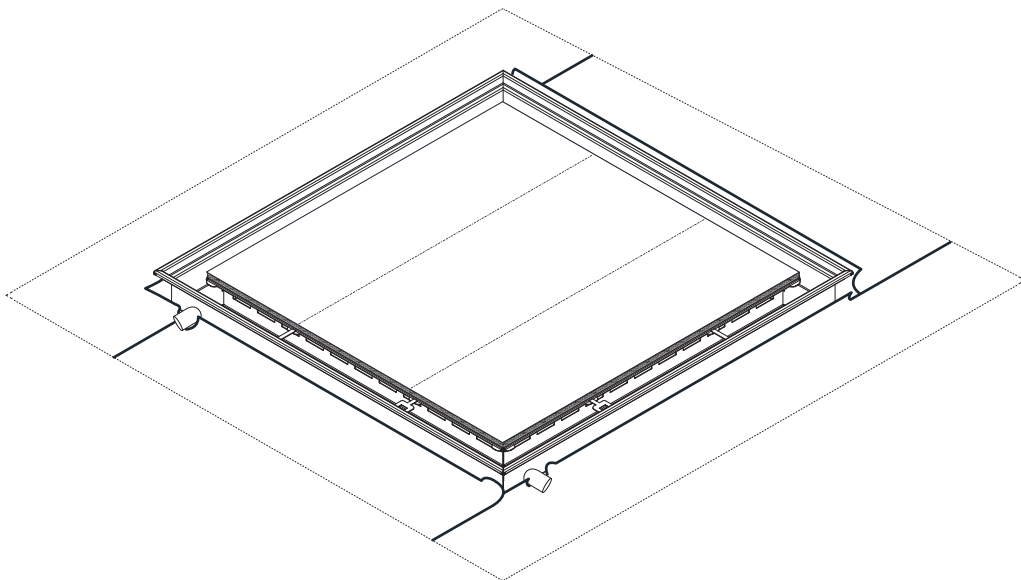

Illustrations may show a different product.

Installation Instructions

Illustrations

Figure B: Junction of the layers of sheathing in the corners and around the drains.

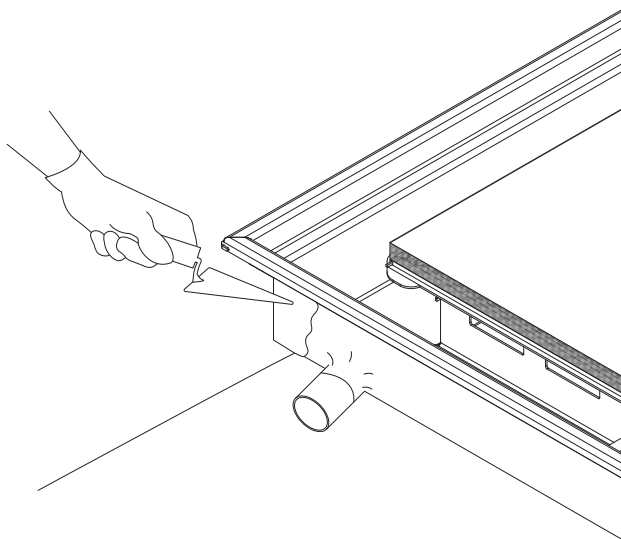

Figure C: Spread the sheath up to the level indicated in the figure.

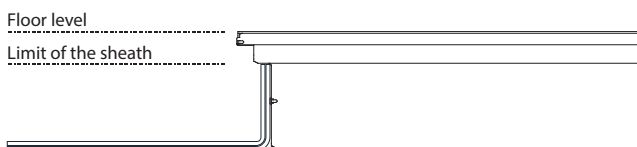
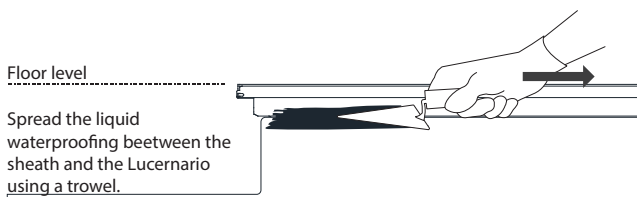

Figure D: Application of the liquid sheath/liquid waterproofing with a trowel.



Illustrations may show a different product.

Installation instructions

Laying Diagrams

These laying diagrams are provided as an example. We recommend that you consult a professional technician who defines the ideal realization of your floor.

Laying Diagrams

Sheath waterproofing is required on all sides.

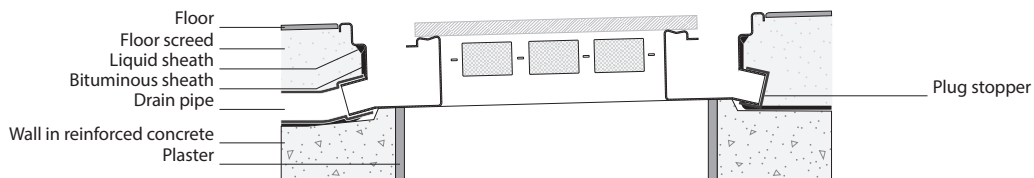

Illustrations may show a different product.

Installation Instructions

Cleaning

1. Cleaning

Clean the Lucernario with water.

To preserve the shine of the finishes, the use of neutral products is recommended.

Always use protective gloves before cleaning the drain.

2. Prohibited products

We forbid the use of abrasive, corrosive and acidic products for cleaning the Lucernario, such as: bleaches, acidic or acid-containing substances, thinners, petrol, substances containing chlorine and corrosive substances.

3. Further notes

Washing with a pressure washer is permitted by keeping the jet at a distance of at least 10 cm.

Technical assistance during the installation

Please contact Bottega del ferro:



Tel: +39 030 2731985



E-mail: assistenza@bottegadelferro.net



WhatsApp: +39 030 2731985

Thank you for purchasing Lucernario aerante INOX.

The product and the trademark Lucernario aerante® are property of Bottega del Ferro. Bottega del Ferro reserves all the rights to modify the characteristics of the products listed without notice.

This document and all others relating to the Lucernario aerante INOX can be found on inox.lucernarioaerante.it.



Bottega del ferro
Via del Boscone, 8
25014 Castenedolo (BS) Italy
T. +39 030 2731985
F. +39 030 2130930
info@bottegadelferro.net
www.bottegadelferro.net
inox.lucernarioaerante.it